

F3 USER'S GUIDE



TRIPLE SCREEN LAPTOP SCREEN EXTENDER

Tips:

1. Make sure all connected cables are firmly plugged into before use.
2. The continuous power required by the product is 10w. Please make sure the laptop's USB-C or USB-A port can support 10W (5V/2A).

Windows

Mac

Android

Product Introduction

F3 is a 14-inch portable dual-screen splitter with a novel structure and strong compatibility. Made of metal and PC material, it is sturdy and durable. The product comes with a full-function TYPE-C and HDMI (MINI) interface expansion, offering strong interface compatibility and faster, more stable data transmission. It supports the quick setup of your personal mobile workstation. It can turn one computer into two or three, allowing you to view content on three screens simultaneously, increasing your productivity by 50% with efficient multitasking. It can solve the problem of insufficient or small screens on the original device.

The F3 product stand can be used as a computer stand, with a full-metal surface structure that helps with heat dissipation. The product's support rod can rotate 360 degrees horizontally and 180 degrees vertically, allowing users to adjust to the appropriate angle according to actual needs. The screen can display both horizontally and vertically, suitable for various environments and meeting various needs. The product comes with a single-screen stand, and the screen can also be used as a single screen, suitable for light entertainment and light office work, making it a comprehensive work and entertainment platform.

Each F3 screen can independently adjust brightness, sound, contrast, and other parameters, and is equipped with MINI HDMI/TYPE-C interface, allowing for multi-functional video expansion without the need for a docking station. As long as your laptop has a 2-in-1 TPYE-C combining signal and power, it can be connected to display immediately. Devices such as desktop computers, laptops with HDMI output interfaces, mini PCs, set-top boxes, and game consoles can be directly connected to the display, but the screen needs an external power supply to light up (you can use a type-c mobile phone charging cable).

The F3 adopts a pull-out structure, solving the problem of adapting to different computer sizes without damaging the computer screen. It is compatible with almost all notebook computers and solves the compatibility problem of dual-screen splitters. F3 splitter integrates single/double screen display, screen storage, screen protection, and computer heat dissipation into a workstation, improving work efficiency while also making the desktop cleaner and more convenient to use, meeting the needs of customers.

About Your Monitor

1.Product Overview	1
2.Product Accessories	1
3.Product Specifications	1

Installation and Storage

1.Installation	2
2.Dual screen set up with computer	3
3.Storage	4

Connection

1.Connect F3 with Laptop	7
2.Connect F3 with Mobile Phone with Other Devices	7

Audio Settings

1.Change sound settings of Windows 10 / Windows 11	8
2.Change sound settings of MAC OS PC	9

Display Mode

1.Windows 10 / Windows 11 Display Settings and Configuration	10
2.MacOS 13 Ventura Display Settings and Configuration	11

Transportation, Storage and Safety Information

	12
--	----

Product Overview

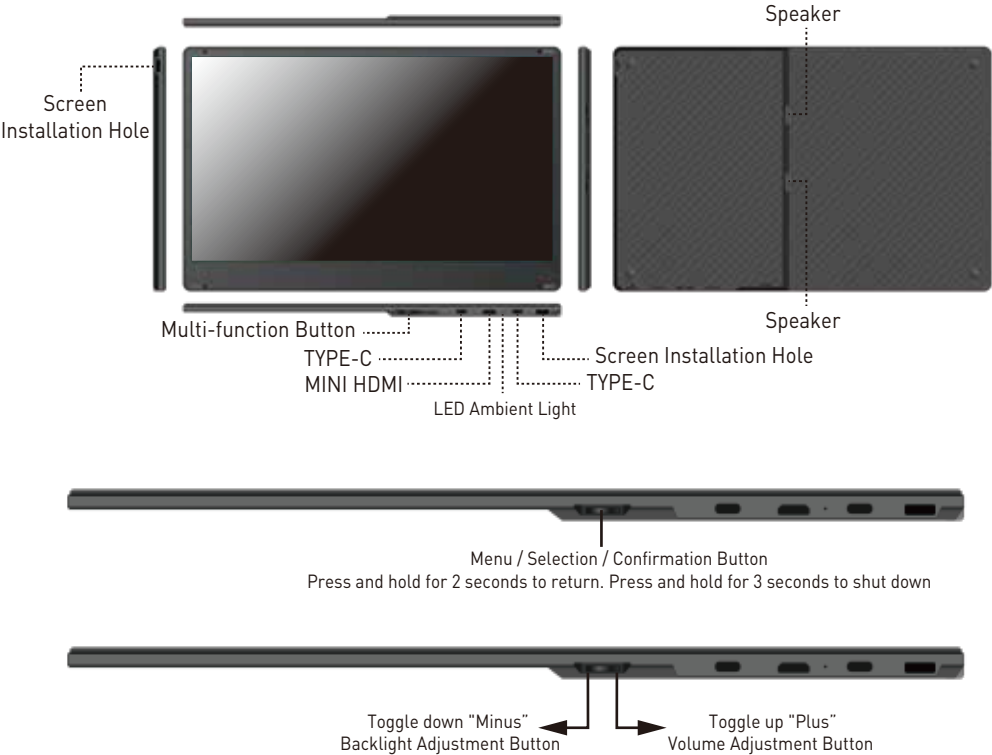

Product Accessories

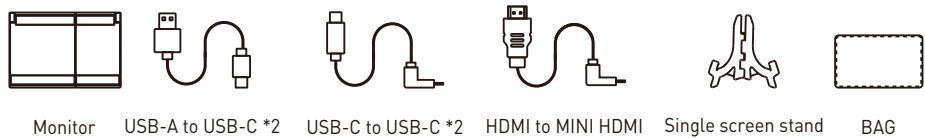

Product Specifications

Product Model:	F3	Product Weight:	2.31KG	Product Size:	363.3x245.5x27.5mm
Resolution:	1920*1080P	Panel Type:	IPS	Loudspeakers:	4 PCS
TYPE-C Input:	5-20V / 5A	TYPE-C Output:	5-20V / 4.25A	Refresh Rate:	60Hz

Installation

Step 1

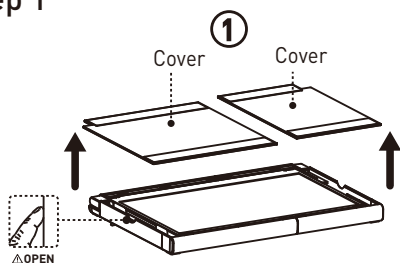

Remove the cover from the left and right stand buckles

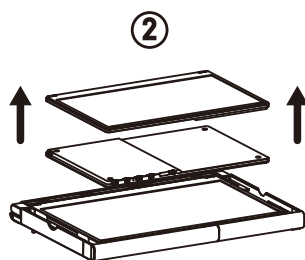

Remove the left and right screens in sequence

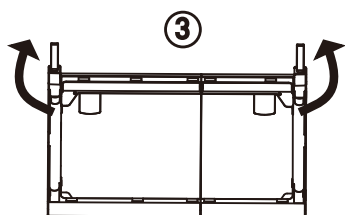

Open the left and right support rods

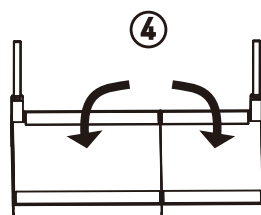

Attach the left and right covers

Step 2

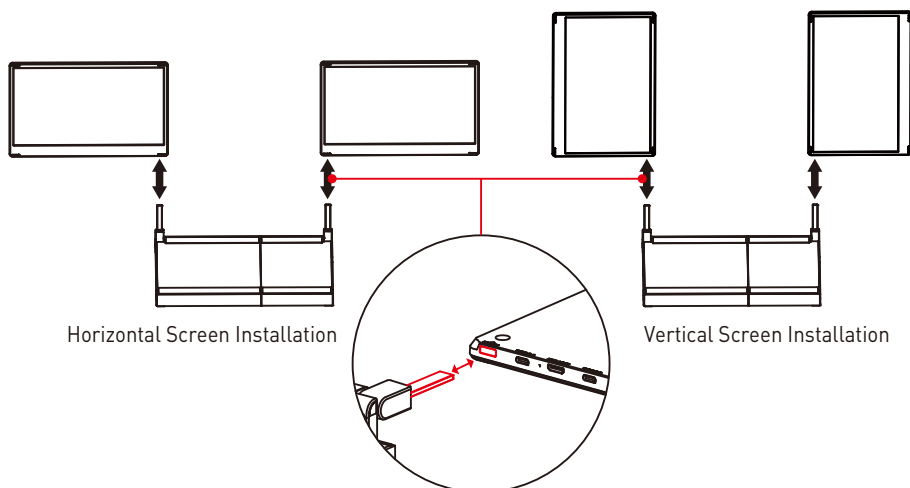

Align the support rod with the screen installation hole for installation

Dual Screen Set up With Computer

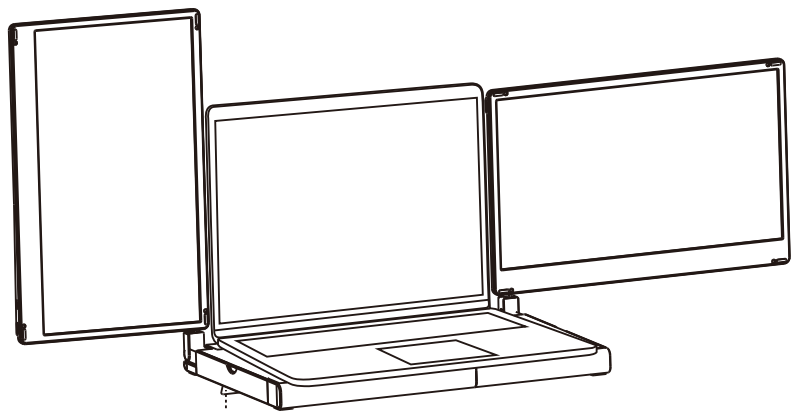

Kickstand

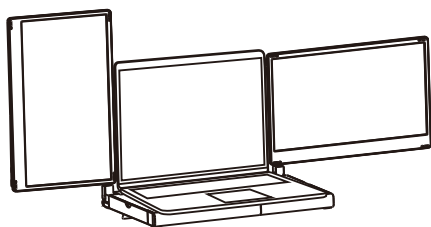

Portrait & Landscape Mode



Detached Mode

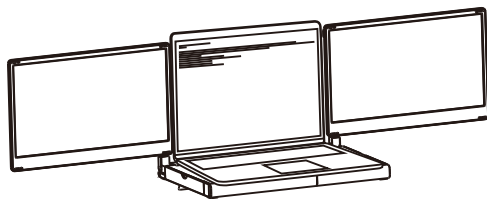

Landscape Display

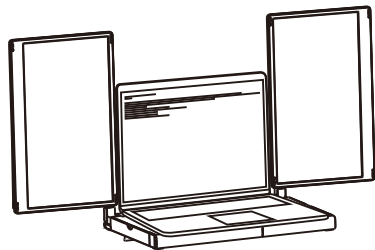

Portrait Display

Storage

Step 1

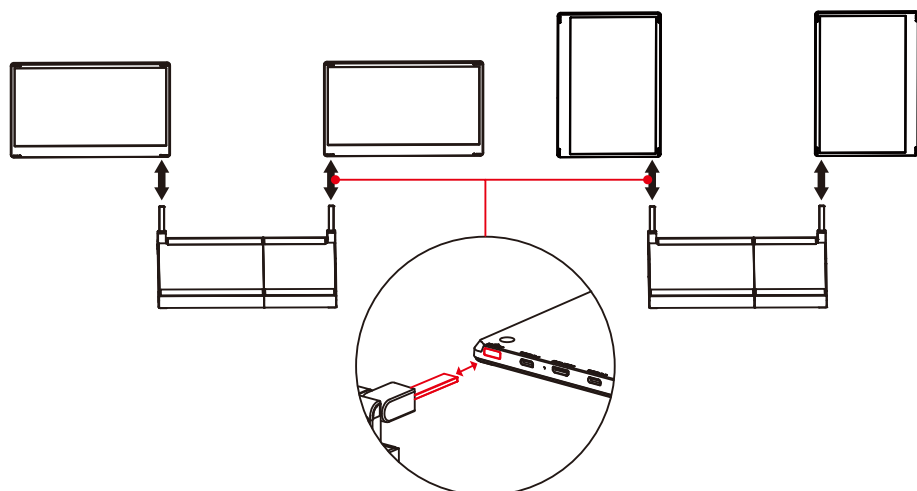

Remove the screen from the stand arm

Step 2

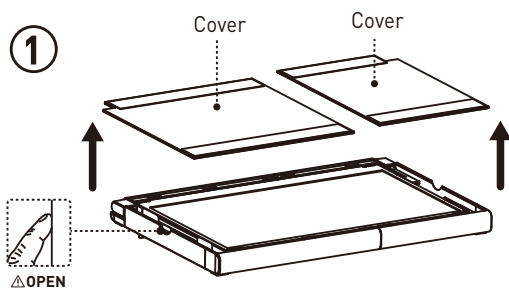

Remove the cover from the left and right stand buckles

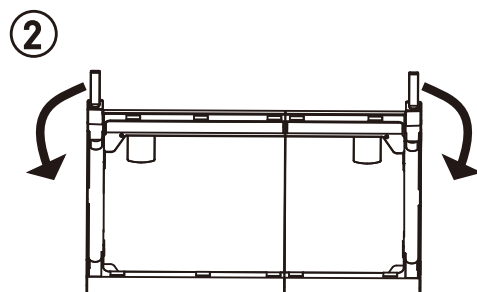

Store the left and right support rods

Storage

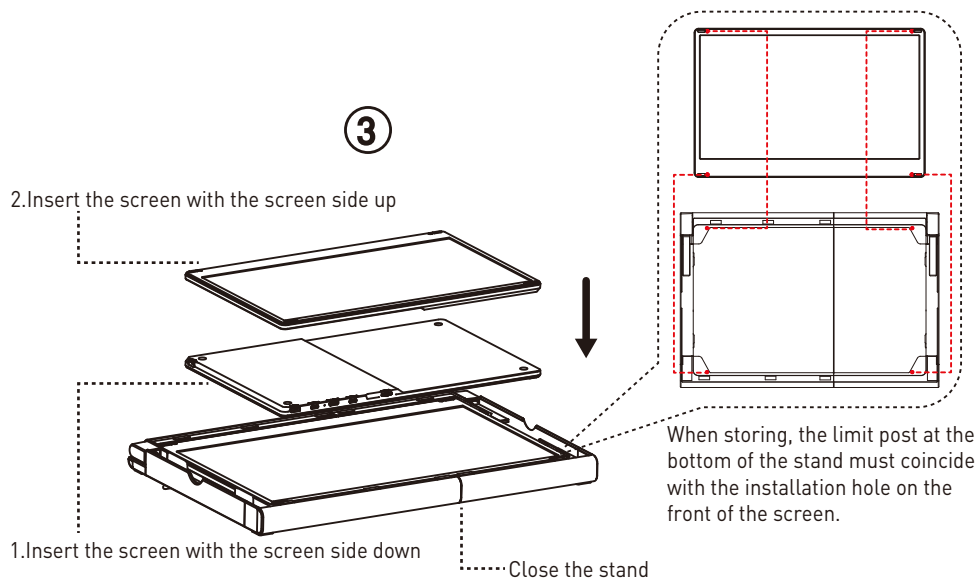

1.Tighten the stand; 2.Insert the bottom screen facing down and the top screen facing up.

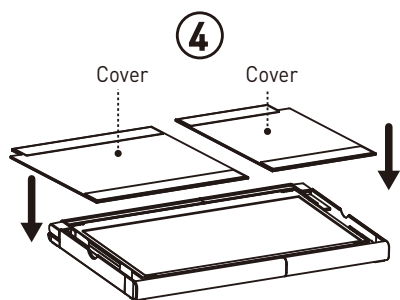

Attach the covers

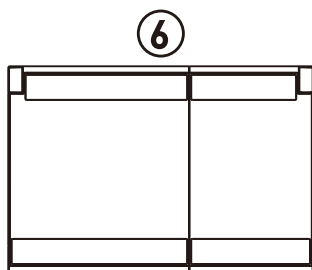

Complete storage

Storage

Single-screen storage.

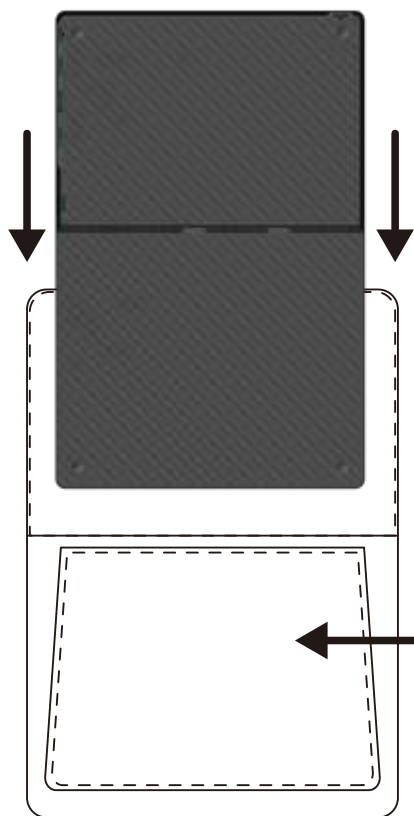

1. Place the thinner edge into the leather case, with the screen facing inward.

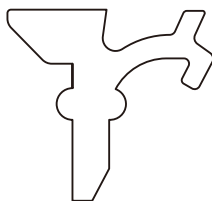

2. Insert the single-screen stand into the storage bag.

Connection

1. Connect F3 with Laptop

TYPE-C Connection:

If your laptop has dual full-functioned Type-C ports, you can use the USB-C to USB-C cable to connect each screen to your laptop. Please connect the cable from the first or second port of the extended screens to the full-functioned Type-C ports of your laptop.

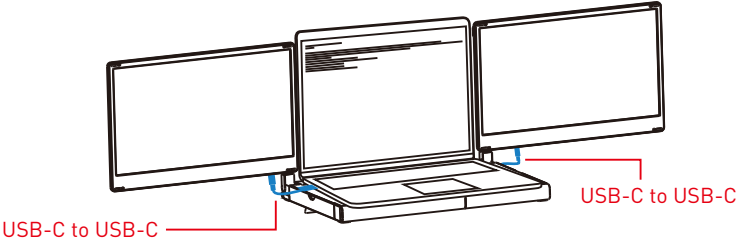
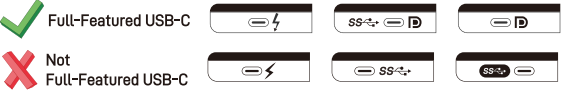

USB and HDMI port Connection:

If your laptop has one USB-A or USB-C port and one HDMI port, please use two cables (one HDMI to MINI HDMI cable + one USB-A or USB-C to USB-C cable) to connect one portable screen. Please use the USB-C to USB-C cable to connect another portable screen with the full-functioned Type-C port of your laptop.

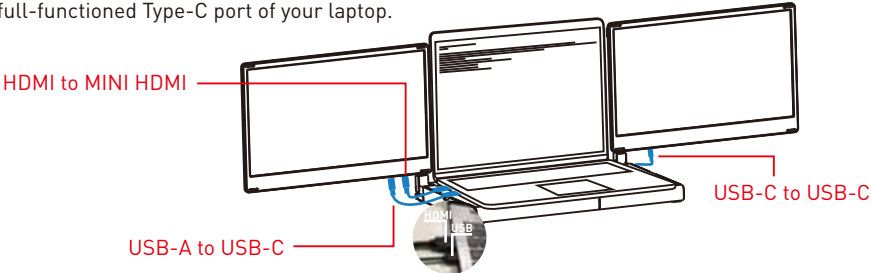

Note: The HDMI-to-MINI HDMI cable must be connected to the MINI HDMI port of the video screen extender. The USB-A or USB-C to USB-C cable must be connected to the first or second port for power supply.

Note: If the display has no signal or the signal is unstable after connection, please connect an external 5V/2A power adapter to power the screen extender.

Note: The USB-C TO USB-C cable / HDMI TO MINI HDMI cable with the L-shaped end connects to the product.

2. Connect F3 with Mobile Phone or Other Devices with HDMI/ full-featured USB-C ports

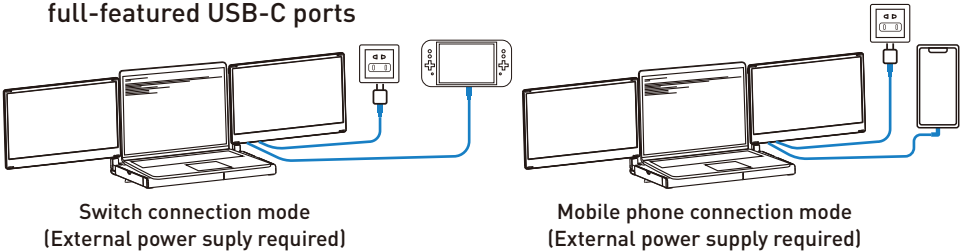

Audio Settings

1. Change sound settings of Windows 10 / Windows 11

1.1 Right click the loudspeaker icon down-right



1.2 Select "switch on sound " in pop-up dialog box

1.3 Left click "turn on sound settings" and pop-up the box as provided,Here users can set about sound;

Here users can set about sound

1. Master volume;

2. Select output device: (F3 / Speaker);

3. Device attributes.

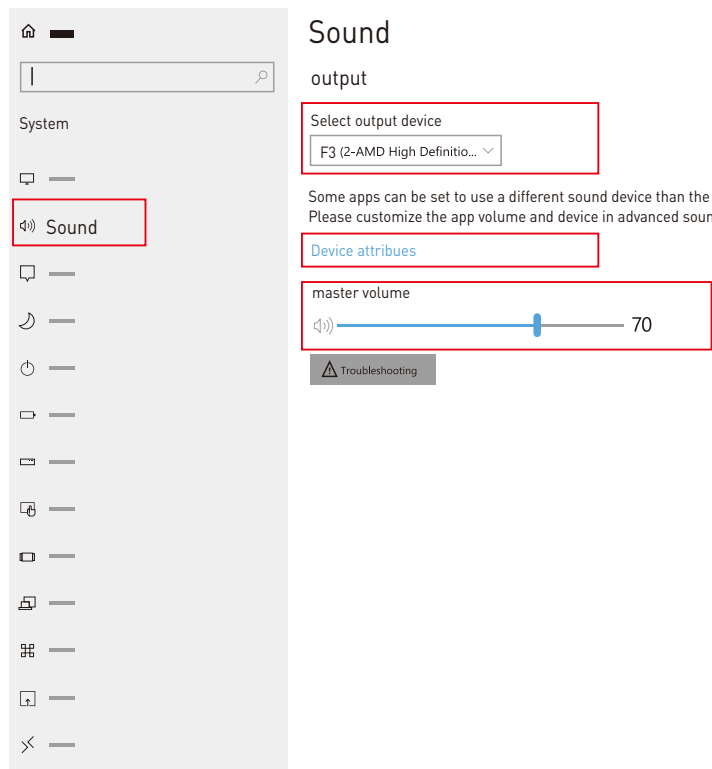

Audio Settings

2. Change sound settings of MAC OS PC

2.1. Choose Apple menu > System Settings



2.2. Click "Output", then select the device you want to use in the list of sound output devices: (F3 / Speaker)

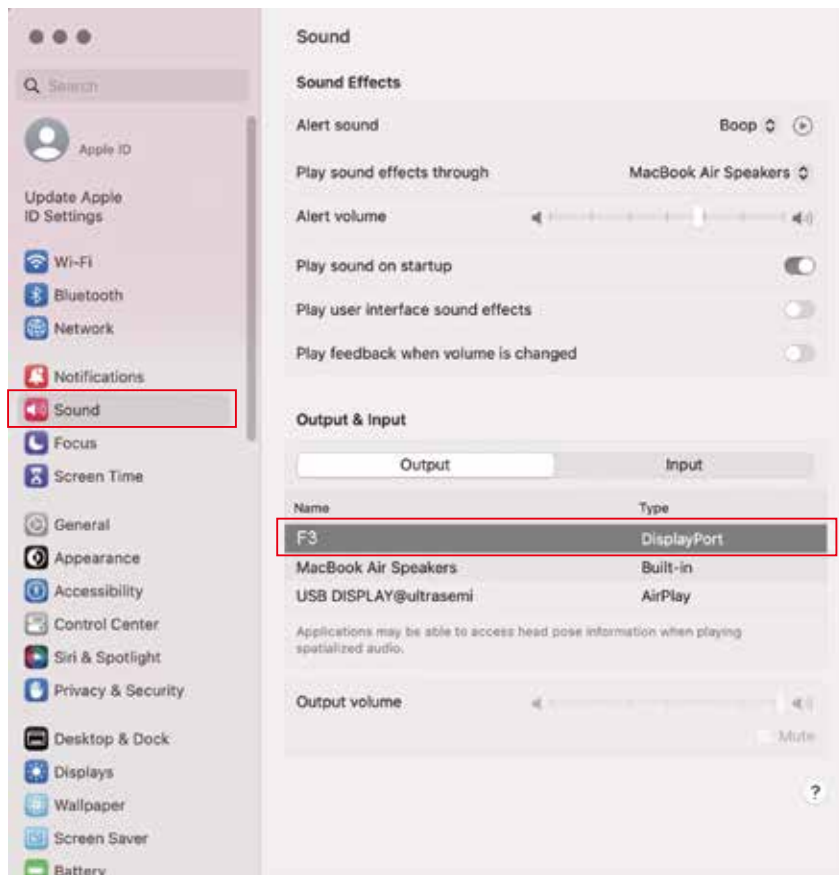

Display Mode

Windows 10 / Windows 11 Display Settings

- 1.Right-click a blank area of the desktop. Select 'Display Settings' from the pop-up dialogue box.
Left-click "Display Settings" to open the settings dialogue box, as shown.

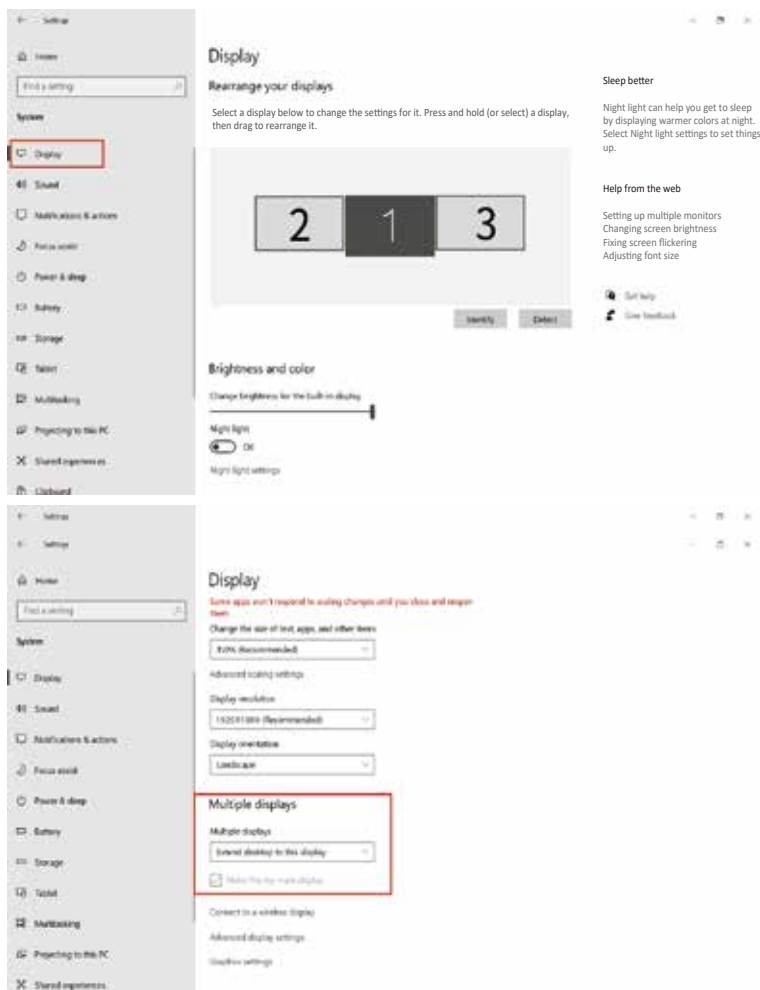

- 2.Under the "Rearrange displays" section, drag and drop each display to rearrange them according to their physical layout on your desktop. Scroll down to the bottom of the page to further configure the display for extended or mirrored mode.

NOTE: When installing vertically, the display direction needs to be rotated (right screen 270 degrees, left screen 90 degrees) in the computer display settings.

Display Mode

MacOS 13 Ventura Display Settings

1.1 Enter the "System Preferences" menu



1.2 Configure your monitor

In this menu, you can set the resolution and mirror/expand the display you want.



1.3 Arrange Displays

To rearrange displays, drag them to the desired position.

To mirror displays, hold Option key while dragging them on top of each other.

To relocate the menu bar, drag it to a different display.



Note: When installing vertically, the display direction needs to be rotated (right screen vertical flip, left screen vertical) in the computer display settings.

Transportation, Storage and Safety Information

In order to ensure the normal use of this product and prevent accidents such as electric shock or fire, please read and understand all use requirements and operation procedures before using.

Please strictly abide by the following requirements.

1. Please tear off the protective film on the screen surface before use.
2. The DC power supply required by this product is AC/DC power adapter, which should be far away from heat source and placed in a well ventilated place. The AC power socket and AC power line should be well grounded and can withstand enough current demand.
3. The DC power input required by this product is $5V-20V \pm 2V$.
4. Attention should be paid to avoid excessive humidity and dust, so as to avoid circuit corrosion and failure.
5. Screen surface should not be challenged by external force.
6. Do not use sharp tools to touch the screen surface.
7. This product fits general business and domestic use, and ambient temperature ranging from $-20\sim 60^{\circ}\text{C}$ is recommended.
8. Please power off power source when stop using device.

