

# M4 USER'S GUIDE



## TRIPLE SCREEN LAPTOP SCREEN EXTENDER

Warm tips:

1. Please ensure type-c cable is connected well with the device interface.
2. This product supports full-featured type-c (charging and video), integrated one line. If the screen cannot be powered on or restarted, please supply external power of 12V / 1.5A.
3. For a better user experience, the screen brightness can only be adjusted to 50% when connected by a single cable. If you need higher brightness, please connect a PD power source or a compatible 12V / 1.5A adapter.

Windows

Mac

Android



## Product Introduction

---

The M4 is a 15.6-inch portable dual-screen splitter with a stand, featuring a novel structure and strong compatibility. Made of PC+aluminum alloy material, it is more durable. The screen comes with a full-function TYPE-C and MINI HDMI interface for external expansion, offering a complete set of interfaces with strong compatibility and faster, more stable data transmission. It can quickly set up a personal mobile workstation. By converting one computer into three or two on three screens, it can increase your productivity by 200%, enabling efficient multitasking. It can solve the problem of insufficient screen size and small screens in original equipment.

The M4 product adopts a dual-link shell structure, and the screen supports 0-330 folding. The screen comes with a stand, supports landscape and portrait display, and supports one-key large-screen display. The upper screen supports one-key 180-degree rotation display. Users can adjust it to the appropriate angle according to their actual needs. It is widely applicable and meets various needs. It is convenient to carry, suitable for light entertainment and office work, and is a comprehensive work and entertainment platform.

The M4 screen supports adjustments for brightness, sound, contrast, and other parameters. It is equipped with MINI HDMI/TYPER-C interfaces, allowing for multifunctional video expansion. As long as it is a TYPE-C laptop with signal and power combination, it can achieve single-cable connection display. For computers that do not support dual-screen expansion, simply connect the computer's MINI HDMI+ USB interface, install the driver, and connect it to the M3 device to light up the dual screens, which is convenient and fast.

---

## Contents Of Instruction

---

### Product Attributes

1. Product Host .....	1
2. Accessories .....	1
3. Parameters .....	1

### Installation and stowing Mode

1. Opening Mode .....	2
2. Display Angle .....	2
3. Product Storage .....	3

### Key Definitions .....

3

### Connection Mode

1. Connect M4 with Laptop .....	4
2. Connect M4 with Mobile Phone .....	4
3. HDMI Connection .....	4

### Driver Installation .....

5

### Audio Settings

1. Change Sound Settings of Windows 10 / Windows 11 .....	7
2. Change Sound Settings of MAC OS PC .....	8

### Display Mode

1. Windows 10 / Windows 11 Display Settings and Configuration .....	9
2. MacOS 13 Ventura Display Settings and Configuration .....	10

### Transportation, Storage and Safety Information .....

11

# Product Attributes

## 1. Product Host

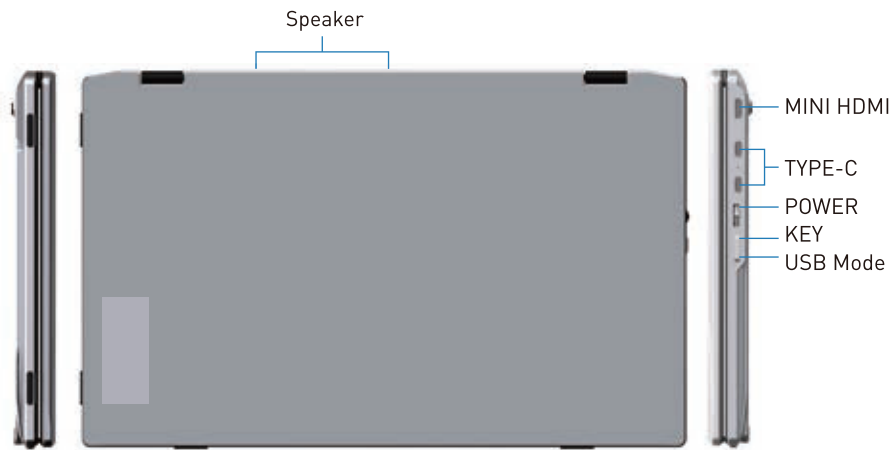

## 2. Accessories

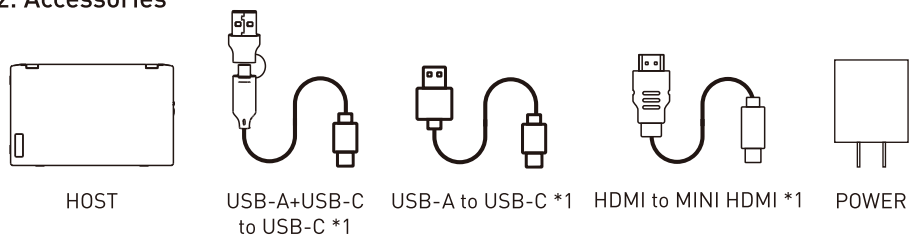

1. USB-A+USB-C to USB-C cable: used to connect the product's TYPE-C interface and the computer's TYPE-C or USB-A interface;
2. USB-A to USB-C cable: used to connect the product's TYPE-C interface and the computer's USB-A interface or USB-A adapter to power the product;
3. HDMI to MINI HDMI cable: used to connect the product's MINI HDMI interface and the computer's HDMI interface.

## 3. Parameters

Weight:	1.495 Kg	Screen Size:	15.6 Inches
Aspect Ratio:	16:9	Panel Type:	IPS Wide Viewing Angle
Size:	360x223.6x24.3mm	Average Brightness:	280CD/M <sup>2</sup>
Refresh Rate:	60Hz	Type-C Input:	5V-20V / 5A Max
Resolution:	1920x1080 P	Type-C Output:	5V-20V / 4A Max
Speaker:	2	Ports:	Type-C*2+MINI HDMI

# Installation And Stowing Mode

## 1. Opening Mode

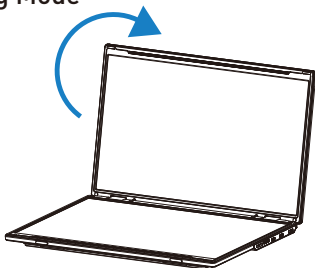

The maximum opening angle of the screen is 330°. It is strictly prohibited to fold it excessively. Please open and close it gently.

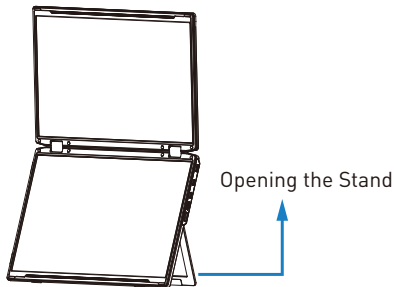

To open the stand, you can adjust it to a maximum angle of 135°.

## 2. Display Angle

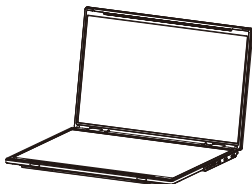

Landscape Display

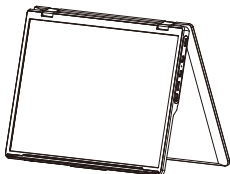

270° Display

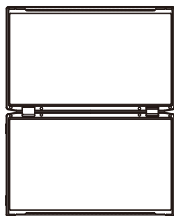

Large Screen Display

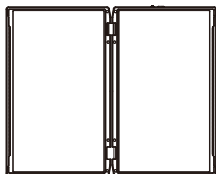

Portrait Display

## 3. Product Storage

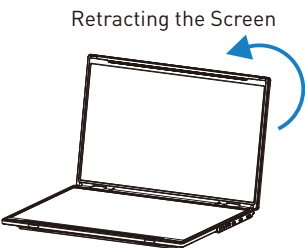
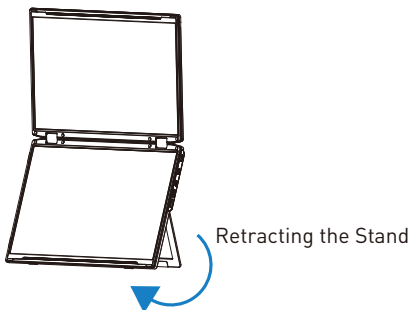

# Key Definitions

To switch to the large screen mode, gently press for one second.

To rotate the display 180°,press for three seconds,then press again for three seconds to return to the previous orientation

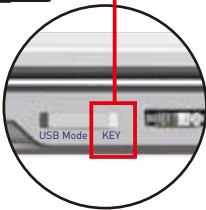
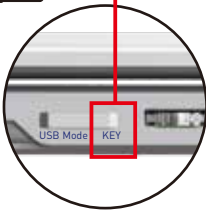
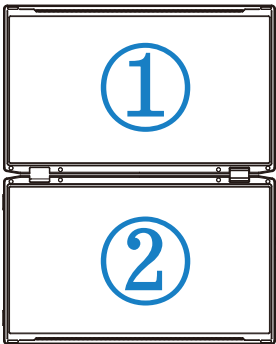
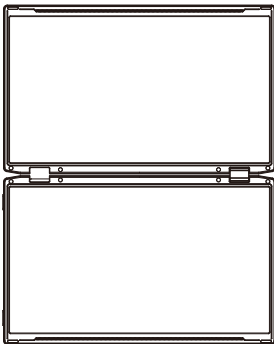

Menu/Selection/Confirmation Button  
Press and hold for 2 seconds to return. Press and hold for 3 seconds to shut down



Toggle right "Plus"  
Volume Adjustment

Toggle left "Minus"  
Backlight Adjustment



If your device does not have a full-function TYPE-C interface,or if it is an M1/M2/M3 chip laptop, you need to press the USB Mode button after connecting the product's TYPE-C interface,switch the USB mode, and install the driver as prompted. Once the installation is complete, you can light up the dual screens.

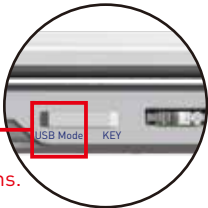

# Connection Mode

## 1. Connect M4 with Laptop

### TYPE-C Connection:

If your laptop has one full-featured Type-C ports, you can connect the M4 directly to your laptop with one Type-C cables.

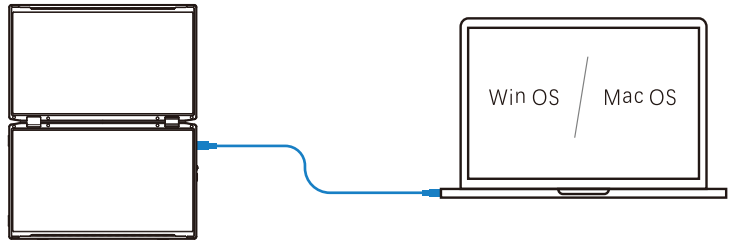

## 2. Connect M4 with Mobile Phone

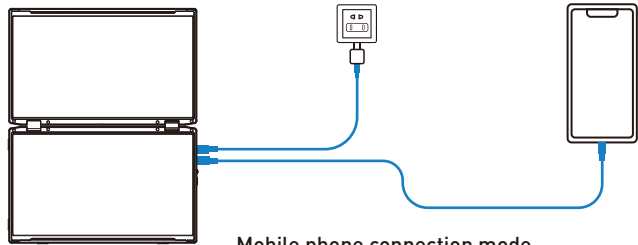

Mobile phone connection mode  
(External power supply required)

## 3. HDMI Connection

If your laptop has HDMI/USB interfaces, you can connect the M4 to the laptop using an HDMI cable, connect to the laptop with a USB-A+USB-C TO USB-C cable, and power the M4 with an external power supply. You can use a USB-A TO USB-C cable to connect to an adapter and then connect it to the M4. (USB driver installation is required)

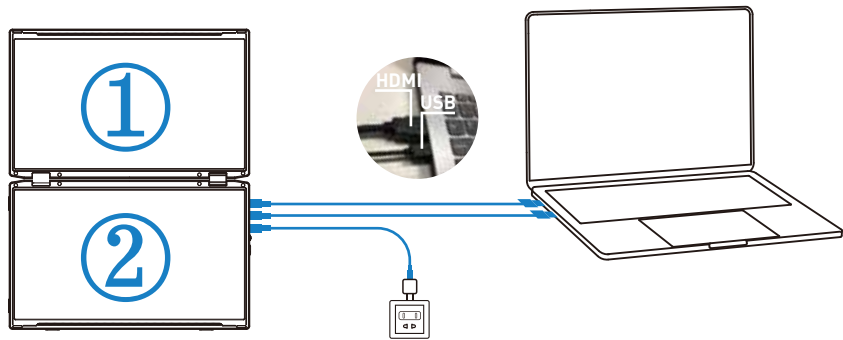

**Note:** When using HDMI connection + external power supply, 1/2 screens will display mirrored.

### Notice:

If the display has no signal or the signal is unstable after connection, please connect an external 12V/1.5A power adapter to power the laptop.



# Driver Installation

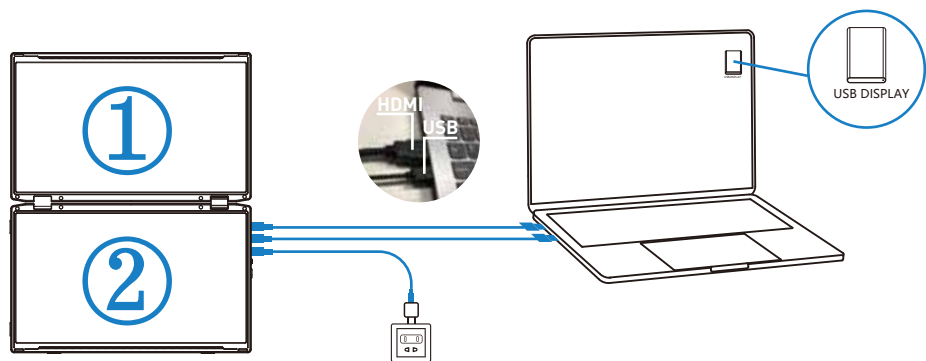

## 1. Windows Driver Installation

For Windows Driver Installation Locate the "USB Display" driver installation file on your computer, double-click to install the driver, and follow the on-screen instructions to complete the installation. Once the installation is complete, the external screen should function properly.

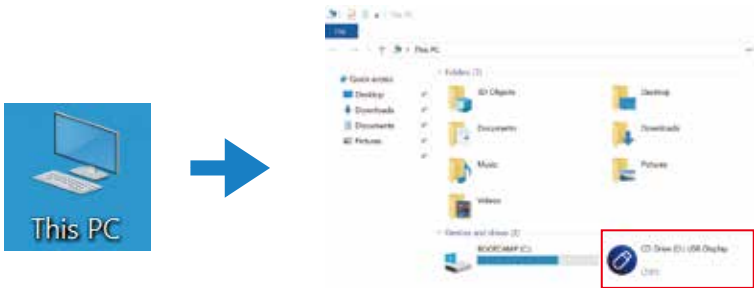

Note: Double-click "USB Display" to install the driver.

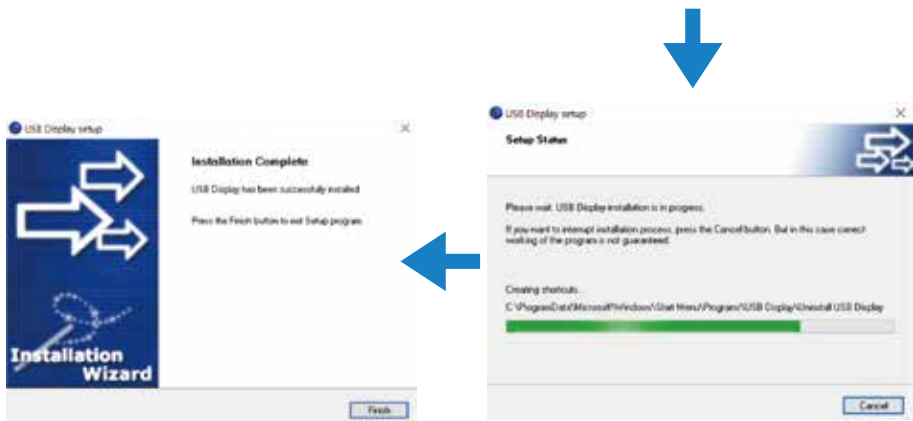

# Driver Installation

## 2. MAC Driver Installation

For MAC Driver Installation Locate the "USB Display" driver installation file on your computer, double-click to install the driver, and follow the on-screen instructions to move the application to the Applications folder. Find the privacy settings, tick the USB Display program. After the installation is complete, the external screen should function properly.



## 1. Change Sound Settings of Windows 10 / Windows 11

1.1 Right click the loudspeaker icon located in the bottom-right corner.

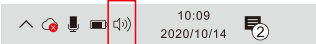

1.2 Select "switch on sound " in pop-up dialog box

1.3 Left click "turn on sound settings" and pop-up the box as provided

### Here users can set about sound

- 1. Master volume;
- 2. Select output device: { M4 / Speaker };
- 3. Device attributes.

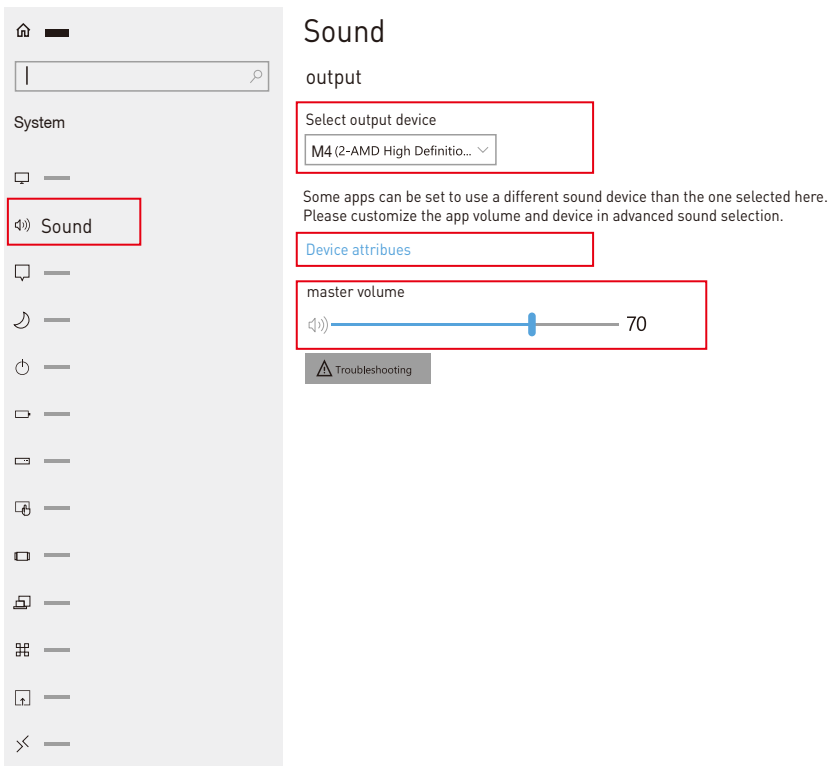

# Audio Settings

## 2. Change Sound Settings of MAC OS PC

2.1. Choose Apple menu > System Settings



2.2. Click on "Output," and then choose the desired device from the list of available sound output options.  
output devices: { M4 / Speaker }

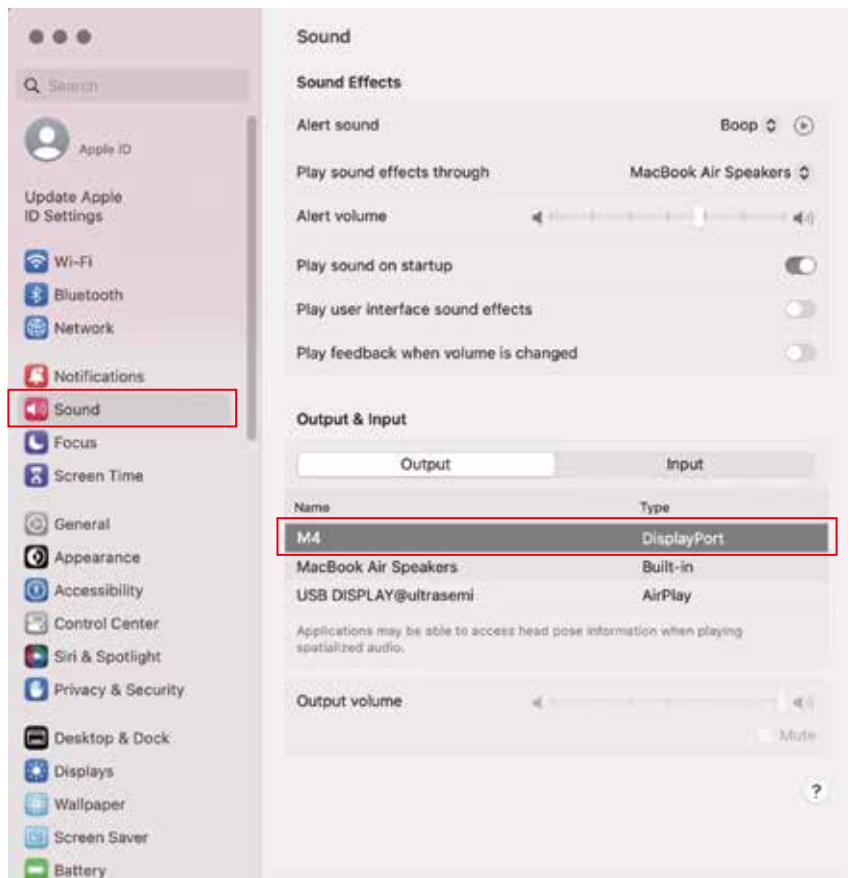

# Display Mode

## 1. Windows 10 / Windows 11 Display Settings

1.1 Right-click a blank area of the desktop. Select 'Display Settings' from the pop-up dialogue box.

Left click "Display Settings" to open the settings dialogue box, shown in the figure:

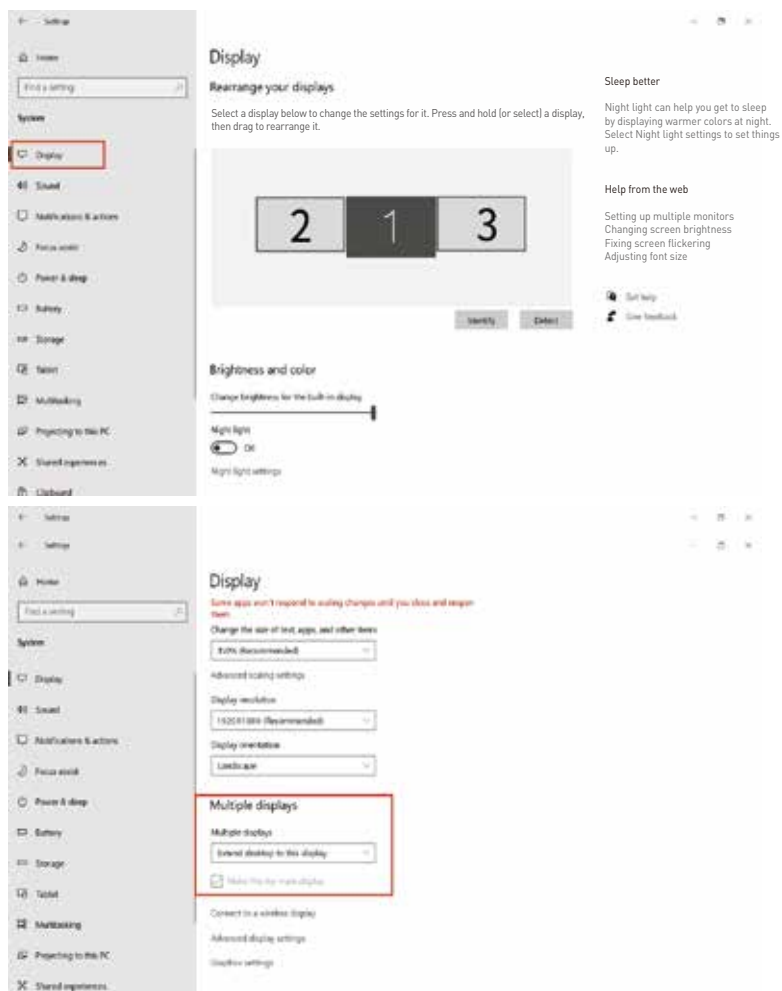

1.2 Under the "Rearrange displays" section, drag and drop each display to rearrange them according to their physical layout of your desktop. Scroll down to the bottom of the page to further configure the display for extended or mirrored mode.

## 2. MacOS 13 Ventura Display Settings

2.1 Enter the "System Preferences" menu



2.2 Configure your monitor

In this menu, you can set the resolution and mirror/extend the display you want.



2.3 Arrange Displays

To rearrange displays, drag them to the desired position.  
To mirror displays, hold Option key while dragging them on top of each other.  
To relocate the menu bar, drag it to a different display.



## Transportation, Storage and Safety Information

---

To ensure the safe and proper use of this product and prevent accidents such as electric shock or fire, please read and understand all use requirements and operation procedures before using.

**Please adhere strictly to the following guidelines:**

1. Before use, remove the protective film from the screen surface.
2. This product requires a DC power supply through an AC/DC power adapter. Ensure that the adapter is placed away from heat sources in a well-ventilated location. The AC power socket and AC power line should be adequately grounded to handle the current demands.
3. The DC power input required for this product is  $5V-20V \pm 2V$ .
4. Take precautions to prevent excessive humidity and dust accumulation, as they can lead to circuit corrosion and malfunction.
5. Avoid subjecting the screen surface to external forces or impacts.
6. Do not use sharp tools that may damage the screen surface.
7. This product is suitable for general business and domestic use, and it is recommended to operate it within an ambient temperature range of  $-20^{\circ}\text{C}$  to  $60^{\circ}\text{C}$ . Please turn off the power when you stop using produce.
8. Remember to power off the device by disconnecting the power source when not in use.

