

Z4 PRO USER'S GUIDE



LAPTOP SCREEN EXTENDER

Warm tips:

1. Please ensure type-c data wire is connected well with device interface.
2. Before using the product, please install the appropriate driver according to your computer's operating system version.
3. When using the product, you must connect a PD adapter of 30W or higher for power supply otherwise, the product will not function properly.

Windows

Mac

Android

Product Introduction

Z4 PRO is a box-style triple-screen workstation featuring a novel structure. It is foldable, large-sized, and easy to store. With one-button screen expansion and support for various usage scenarios, it helps you quickly set up a personal mobile studio. It provides the perfect solution for laptop users to achieve both synchronized multi-screen and split-screen displays, potentially increasing work efficiency by up to 150% and enabling highly efficient multitasking. It also supports screen mirroring with selected Samsung, Huawei, and other branded smartphones, as well as computer modes on smart devices and audio/video transmission.

Z4 PRO's stand is easy to use—simply open the stand, remove the screens, and mount them. The magnetic mount securely holds the screens in place. It supports laptops, desktop computers, mini PCs, gaming consoles, and more. It is suitable for a variety of environments, offering tailored experiences for professionals, office workers, gamers, stock traders, entrepreneurs, programmers, and students.

The Z4 PRO screens allow adjustment of brightness, volume, contrast, etc. It features full-function Type-C and PD power interfaces, supporting versatile video and data expansion without needing a docking station. Devices with Type-C/HDMI/USB-A ports are supported (driver installation required).

Note: The screens require an external power supply to function.

Finally, the Z4 PRO supports 360-degree rotation, letting users freely adjust to their preferred viewing angle for an optimal visual experience.

Contents of Instruction

Product Attributes

- 1. Product host 1
- 2. Accessories 1
- 3. Parameters 1

Installation and Storage

- 1. Installation and Storage 2
- 2. Adjust the kickstand 2
- 3. Screen Installation Direction 3
- 4. Closing Sequence 4

Key Definitions 5

Driver Installation 6

Connection

- 1. Connect Z4 PRO with Laptop 6

Audio Settings

- 1. Change sound settings of Windows 10 / Windows 11 8
- 2. Change sound settings of MAC OS PC 9

Display Mode

- 1. Windows 10 / Windows 11 Display Settings and Configuration 10
- 2. macOS Ventura 13 Display Settings and Configuration 11

Transportation, Storage and Safety Information 12

Product Attributes

1. Product host

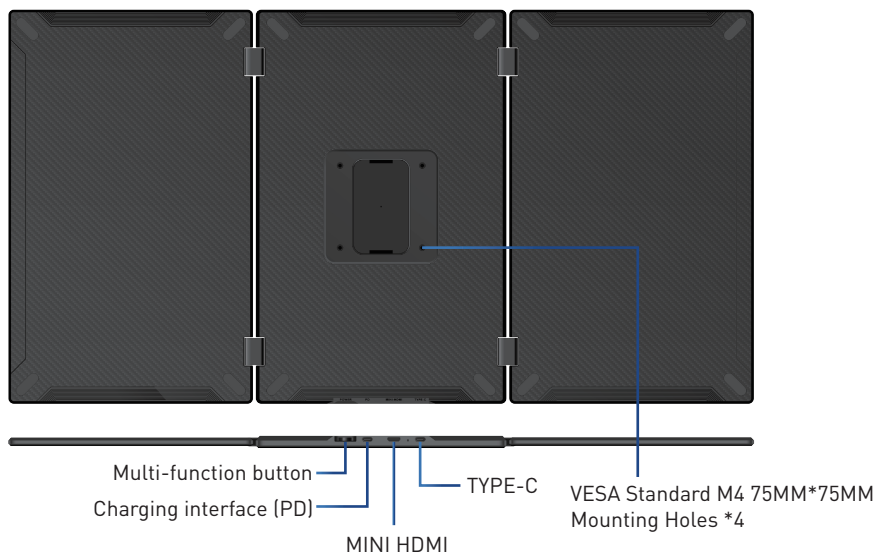

2. Accessories



Monitor

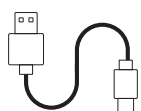

USB-A to USB-C

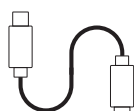

USB-C to USB-C x2

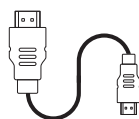

HDMI to MINI HDMI



Power Adapter



USB Flash Disk

3. Parameters

Weight:	3.7 Kg	Screen Size:	15.6 Inches
Aspect Ratio:	16:9	Panel Type:	IPS Wide Viewing Angle
Size:	444.5×244×40.9mm	Average Brightness:	300cd/m ²
Refresh Rate:	60Hz	Type-C Input:	5V-20V / 5A Max
Resolution:	1920×1080	Type-C Output:	5V-20V / 3.5A Max
Speaker:	2	Ports:	Type-C×2+MINI HDMI

Installation and Storage

1. Expand the monitor

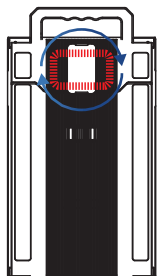

1. Rotate the magnetic turntable to the horizontal direction.

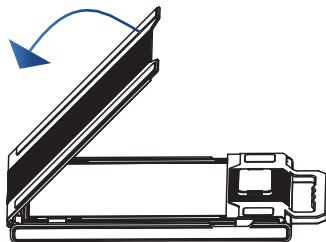

2. Open the outer cover on the left.

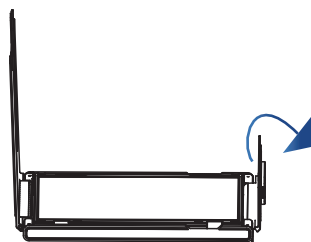

3. Open the outer cover on the right.

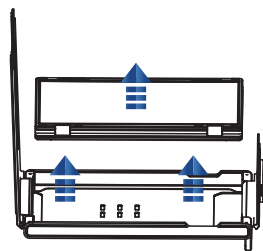

4. Take out the screen upwards.

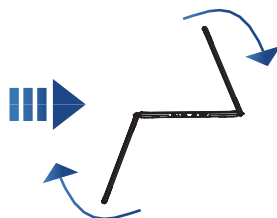

***NOTE:**

1. Please follow the direction to expand the monitor to avoid damage.
2. To store the screen, follow the above sequence and operate in reverse.

2. Adjust the kickstand

Scenario 1

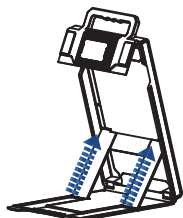

1. Install the support rod into the positioning hole of the bracket base plate.

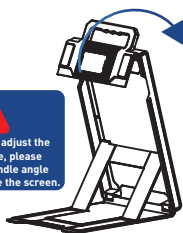

2. Adjust the handle to the appropriate angle.



3. Align the screen mounting holes with the suction cup bracket and secure them in place.



4. Enable landscape display mode.

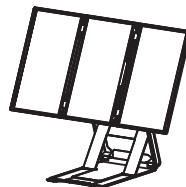

5. Enable portrait display mode.

Installation and Storage

Scenario 2

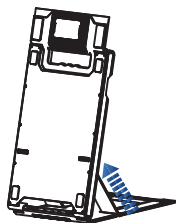

1. Install the support rod into the positioning hole of the bracket base plate.

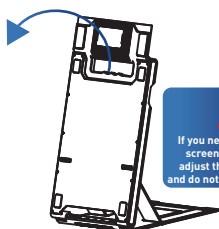



If you need to adjust the screen angle, please adjust the handle angle and do not move the screen.

2. Adjust the handle to the appropriate angle.

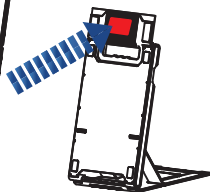

3. Align the screen mounting holes with the suction cup bracket and secure them in place.



4. Enable landscape display mode.

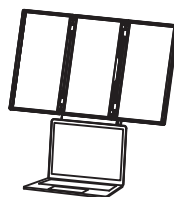

5. Vertical display mode, and this configuration is suitable for placement behind the laptop monitor.

3. Screen Installation Direction

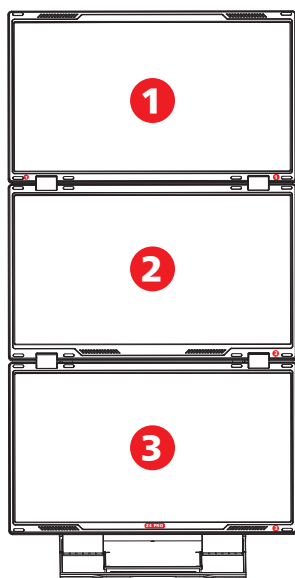

Note: The interface should face to the right

Note: The interface should face to the right, and the LOGO should be installed facing downward.

Installation and Storage

4. Closing Sequence

1. Disassemble the foldable screens

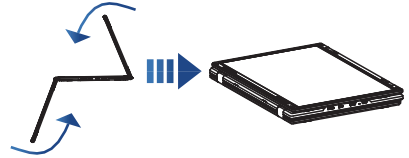
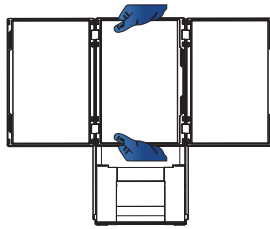

Please move the screen away from this area to prevent damage to it.

The right screen faces upward when stored, and the left screen faces downward when stored.

2. Store the stand and screens

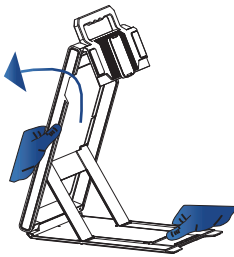

1. Open the main body of the bracket to the left and remove the support bracket.

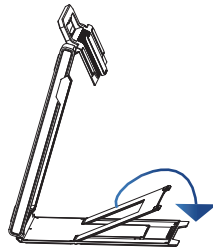

2. Store the support rods in the storage slots.

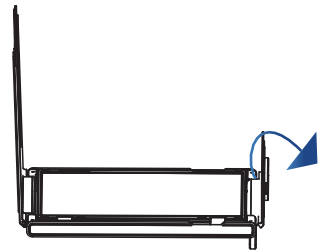

3. Open the stand

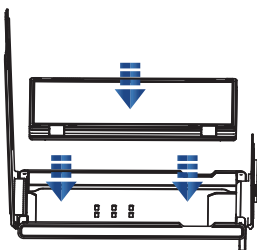

4. Insert the screens

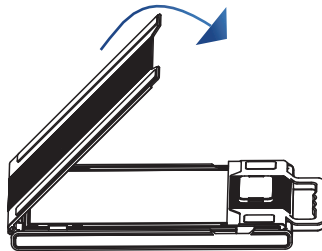

5. Close the stand

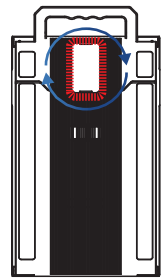

6. Lock the magnetic base

*NOTE:

1. Please follow the sequence of opening and closing to avoid damage.

2. When the product is stored, the magnetic base must be locked before it can be carried by hand, otherwise there is a risk of the screen falling off and breaking.

Key Definitions

1. Menu Key / Plus Key / Minus Key Usage:

1. Press the middle button to enter the settings menu.
2. In the settings menu, press the button upward to move up, downward to move down. Press the middle button to confirm selection.
3. Press the button upward to increase parameter values, downward to decrease parameter values, then press the middle button to confirm. The same method applies to adjusting other parameters.
4. Press the middle button for 2 seconds to return to the previous menu.
5. Press the middle button for 3 seconds to turn off the screen.

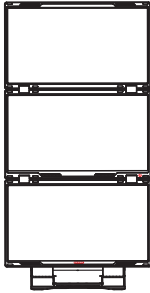

Menu/Selection/Confirmation Button
Press and hold for 2 seconds to return.
Press and hold for 3 seconds to shut down.

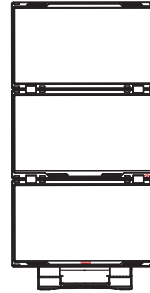

Toggle right "Plus"
Volume Adjustment

Toggle left "Minus"
Backlight Adjustment

2. One-Key Large Screen Mode

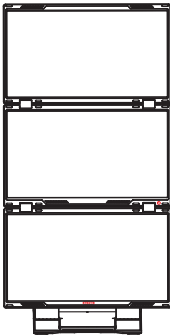

1. Press the button upward for 3 seconds to switch to one-key large screen mode, with a resolution of 2160×1280 60Hz.
2. Press the button upward for 3 seconds to exit one-key large screen mode.
3. To enter one-key large screen mode, the following conditions must be met:
 1. The product's MINI HDMI interface must have a signal connection.
 2. The product's TYPE-C interface must be connected to the computer's full-function TYPE-C interface.

3. Turn off the display screen

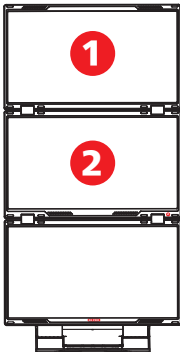

1. Press the button downward for 3 seconds to turn off the three screens.
2. Press the button downward for 3 seconds to turn on the three screens.

Driver Installation

1.Driver Installation for Computers

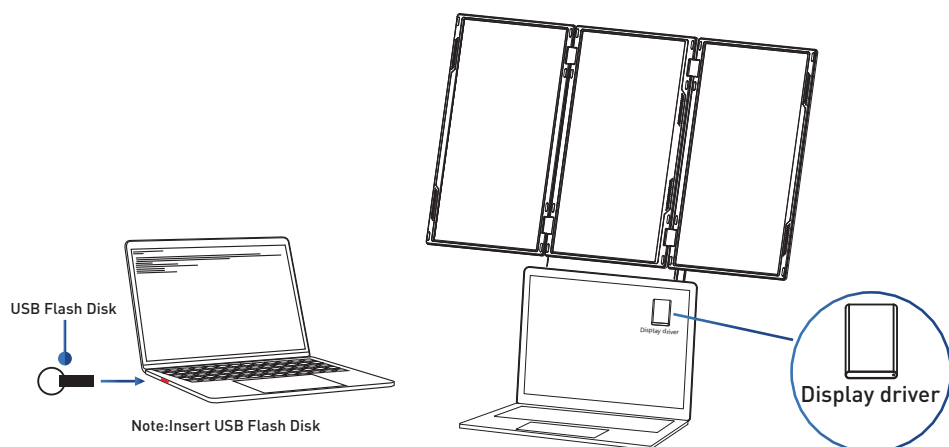

Note: When connected, your laptop will automatically install the necessary drivers. To manually install, run the **(SMIUSBdisplaysW.exe)** file located in the USB Flash Disk drive. For MacOS Systems, install the appropriate **(InstantView.exe)** driver and follow the on-screen instructions.

Connection Mode

1. Connect Z4 PRO with Laptop

TYPE-C Connection:

If your laptop has a full-featured Type-C port, use a USB-C to USB-C cable to connect the device to the laptop. Simultaneously, power the device via the included PD adapter and USB-C to USB-C charging cable.



Full-Featured USB-C

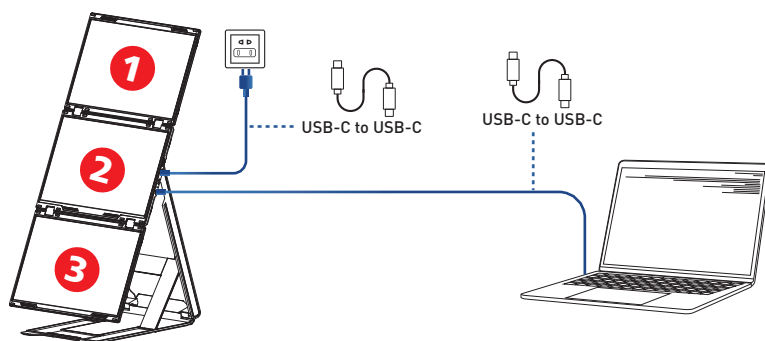

Note:

1. This connection method supports one-button large screen mode.
2. Before using the product, install the driver first.

Connection Mode

USB-A+HDMI Port Connection:

If your laptop has USB-A+HDMI ports, you can directly connect the Z4 PRO to the laptop's USB-A and HDMI ports using a USB-A to USB-C and HDMI to MINI HDMI cable. Please connect the external adapter to the product's PD interface via USB-C to USB-C for power supply the adapter is included in the package.

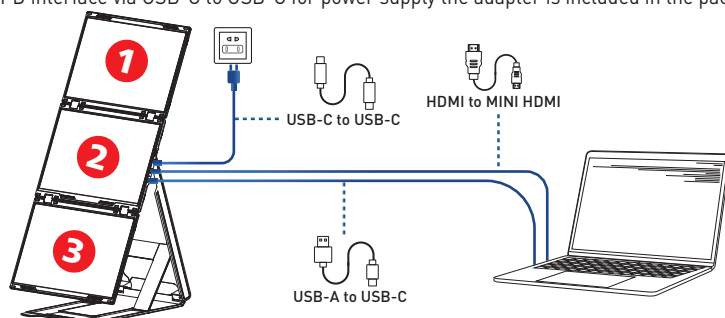

Note: This connection method supports one-button large screen mode.

HDMI Port Connection:

If your laptop has an HDMI port, connect the screen using an HDMI-to-Mini HDMI cable. Simultaneously, power the device via the included PD adapter and USB-C to USB-C charging cable.

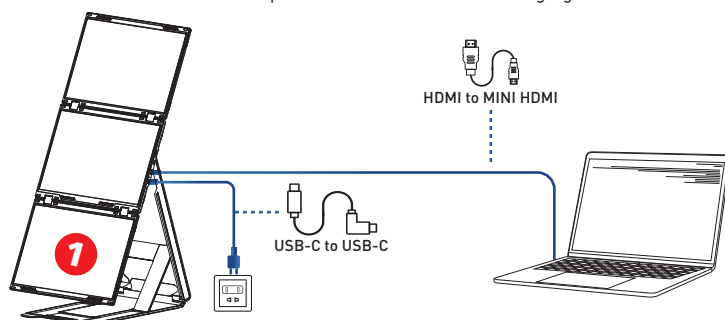

Note: This connection method supports one-button large screen mode.

USB-A Port Connection:

If your laptop has a USB-A port, you can directly connect the Z4 PRO to the laptop's USB-A port with a USB-A TO USB-C cable. please connect an external adapter to the product's PD interface for power supply. The adapter is included in the package.

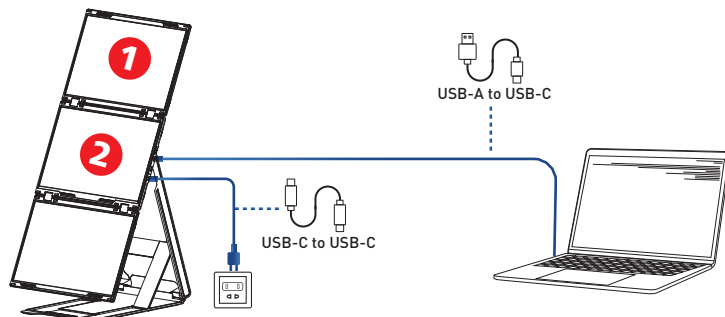

Note: The large screen mode is exclusively activated under the condition of PD power supply combined with Type-C and HDMI connections, which supports notebook charging. However, enabling the large screen mode through other connection methods does not facilitate notebook charging functionality.

1. Change sound settings of Windows 10 / Windows 11

1.1 Right click the Loudspeaker icon located in the bottom-right corner;



1.2 Select "switch on sound" in pop-up dialog box;

1.3 Left click "turn on sound settings" and pop-up the box as provided, Here users can set about sound.

Here users can set about sound

1. Master volume;
2. Select output device: { Z4 PRO / Speaker };
3. Device attributes.

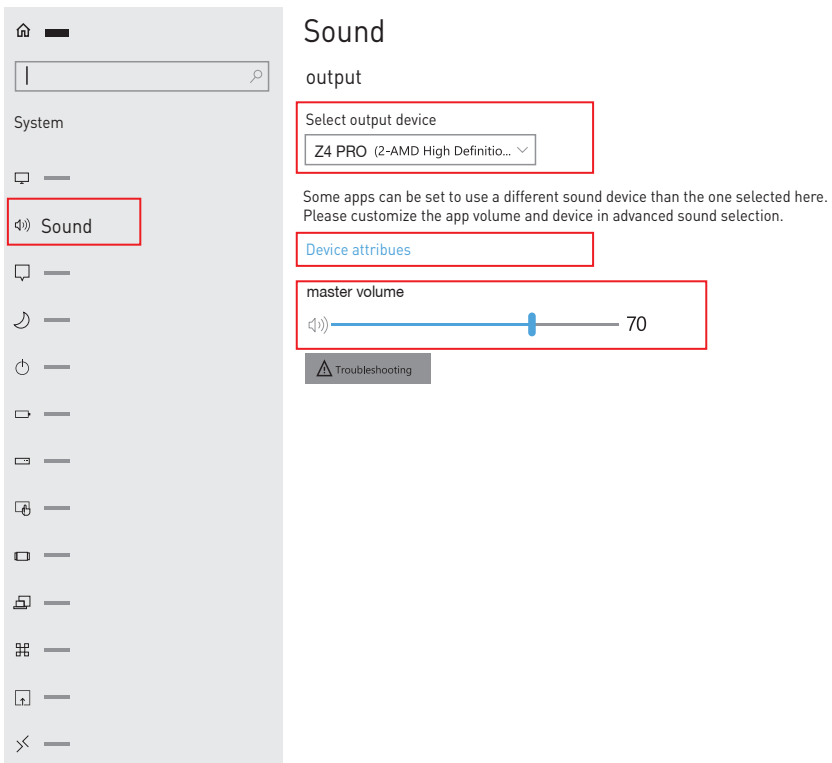

Audio Settings

2. Change sound settings of MAC OS PC

2.1. Choose Apple menu > System Settings



2.2. Click on "Output", and then choose the desired device from the list of available sound output options.

Output devices: { Z4 PRO / Speaker }

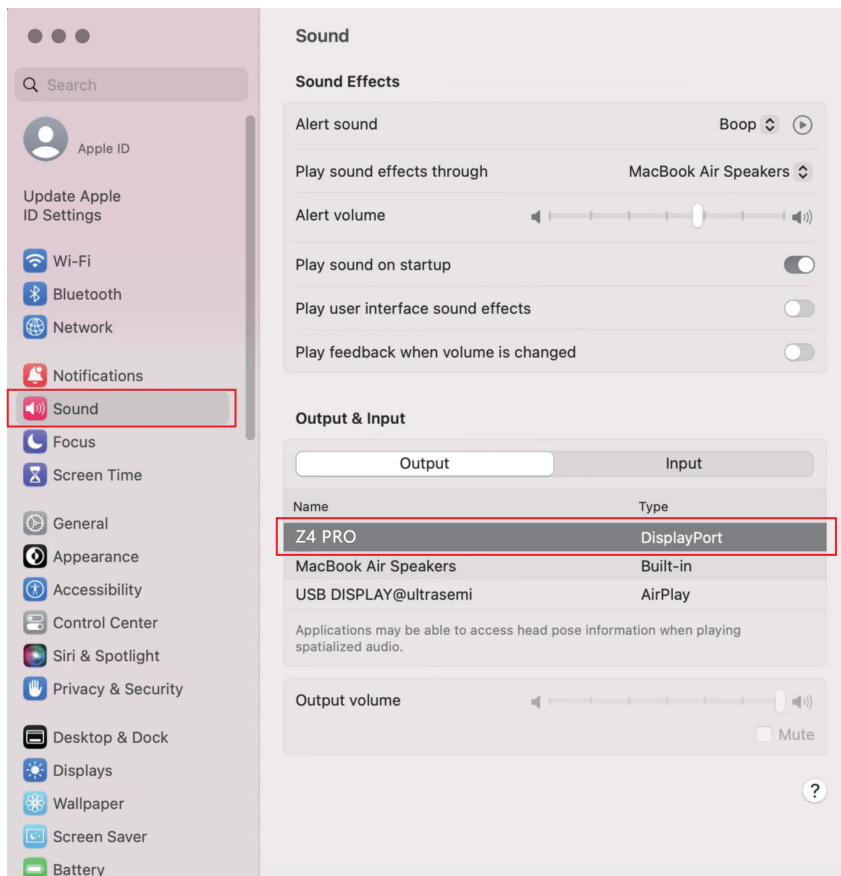

1. Windows 10 / Windows 11 Display Settings

1.1 Right-click a blank area of the desktop. Select 'Display Settings' from the pop-up dialogue box.

Left-click "Display Settings" to open the settings dialogue box, as shown.

1.2 Under the "Rearrange your displays" section, drag and drop each display to rearrange them according to their physical layout of your desktop. Scroll down to the bottom of the page to further configure the display for extended or mirrored mode.

1.3 Under the extended mode, drag the files, video or others from your laptop and move right to the screen extender; or drag the file or video you need from the screen extender and move left back to your laptop.

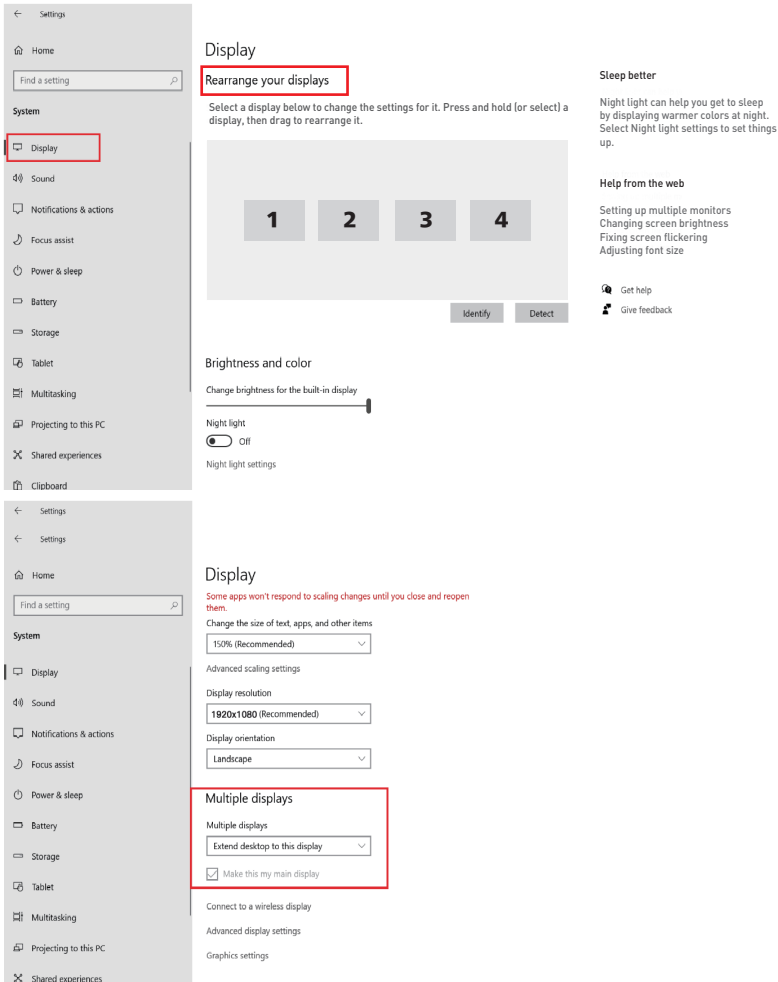

2. macOS Ventura 13 Display Settings

2.1 Enter the "System Preferences" menu



2.2 Configure your monitor

In this menu, you can set the resolution and mirror / extend the display as you want.

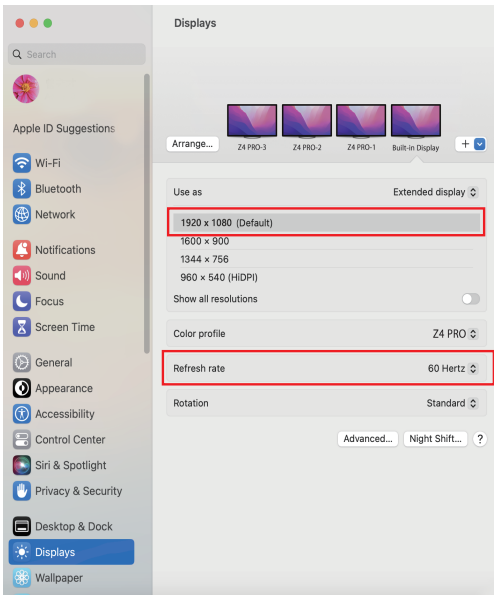

2.3 Arrange Displays

To rearrange displays, drag them to the desired position.

To mirror displays, hold Option key while dragging them on top of each other.

To relocate the menu bar, drag it to a different display.

Arrange Displays

To rearrange displays, drag them to the desired position. To mirror displays, hold Option while dragging them on top of each other. To relocate the menu bar, drag it to a different display.

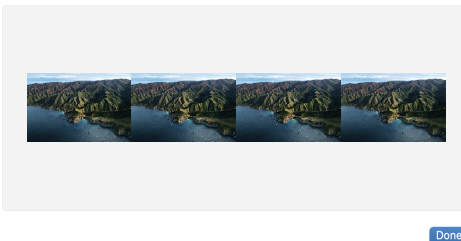

Transportation, Storage and Safety Information

To ensure the safe and proper use of this product and to prevent potential accidents such as electric shock or fire, please carefully read and understand all usage requirements and operational procedures before using. Adhere strictly to the following guidelines:

1. Before use, remove the protective film from the screen surface.
2. This product requires a DC power supply through an AC/DC power adapter. Ensure that the adapter is placed away from heat sources in a well-ventilated location. The AC power socket and AC power line should be adequately grounded to handle the current demands.
3. The power requirement for this product is PD30W or higher.
4. Take precautions to prevent excessive humidity and dust accumulation, as they can lead to circuit corrosion and malfunction.
5. Avoid subjecting the screen surface to external forces or impacts.
6. Do not use sharp tools that may damage the screen surface.
7. This product is suitable for general business and domestic use, and it is recommended to operate it within an ambient temperature range of -20°C to 60°C.
8. Remember to power off the device by disconnecting the power source when not in use.